

Approvals

DATUM : GEODETIC 1949
 BOP CIRCUIT COORDINATES
 ORIGIN : MAKETU
 700,000mN 300,000mE

LAND TO BE USED FOR TREATY SETTLEMENT

Shown	Description	Comprised in	Area
Sec 1	Bed of Lake Tarawera	Crown Land sec 27 Maori Land Amendment and Maori Land Claims Adjustment Act 1922	4148.4000ha
	Pt Ruawahia 3	Lake Tarawera Scenic Reserve Gaz 1974 p13	

Lake boundaries shown A-B, C-D, E-F, G-H, I-J, K-L, M-N, O-P, & Islands, have been digitised from Rotorua District Council's Orthophotos 2001

Section 1 has been defined on the understanding that Treaty settlement legislation will exempt it from the provisions of Section 11 and Part X of the Resource Management Act 1991 and Part IVA Conservation Act 1987. Natural boundaries are subject to the normal common law rules of accretion and erosion.

Islands shown hereon are excluded from Section 1

Stratum Parcel:
 The upper limit of Section 1 is the bed of Lake Tarawera
 CLASS OF SURVEY : III

Total Area 4148.4000 ha

Comprised in Gaz 1974 p13 & Crown Land sec 27 Maori Land Amendment and Maori Land Claims Adjustment Act 1922

I, Michael Patrick Flaherty, being a person entitled to practise as a Licensed Cadastral Surveyor, certify that:
 (a) The Surveys to which this dataset relates are accurate, and were undertaken by me or under my direction in accordance with the Cadastral Survey Act 2002 and the Surveyor General's Rules for Cadastral Survey 2002/2;
 (b) This dataset is accurate and has been created in accordance with that Act and these Rules.

Signed at Rotorua Date 13/10/04

Field Book.....p..... Traverse Book.....p.....
 Reference Plans, ML 5342, C.M.R.A2 & B2, ML 20794
 SO 18552, 24222/10, 41758, 45482&5, DPS 13945
 Examined..... Correct.....

Approved as to Survey

..... Approving Surveyor

Deposited this day of 20....

..... for Registrar-General of Land

File Received 20-10-04 Instructions
SO 338996



approved as to Survey by
 and information N.Z. on 16/11/2004
 deposited by Land Information N.Z.
 on

Lake Tarawera
 Sht 1 of 5

LAND DISTRICT SOUTH AUCKLAND
 NZMS 261 Sht RECORD MAP No

Section 1

TERRITORIAL AUTHORITY ROTORUA DISTRICT
 Surveyed by Flaherty Survey & Mapping Ltd
 Scale: 1: 30,000 Date: JANUARY 2000

JTG



Approvals

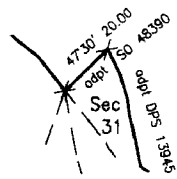

DIAGRAM A
Distorted

Rotomahana
Parekarangi 6B

Rotomahana
Parekarangi 6B

Rotomahana
Parekarangi 6B

Otumutu Is.

SPENCER RD

Sec 20
Blk III Tarawera SD
Rec Res

adpt SO 18552

Lake Tarawera

Sec 1
(Lower Stratum)

adpt ML 5342R

See Diagram A

Rotomahana
Parekarangi
6C2B

Sec 31
Blk VII
Tarawera SD
Esp Res
Gaz 1976 p655

adpt DPS 13945

Former Lake Bed
Crown Land sec 27
Maori Land Amendment
and Maori Land Claims
Adjustment Act 1922

adpt ML 5342 B2

Approved as to Survey by
Land Information NZ on 16.11.2004
Deposited by Land Information NZ

on

CLASS OF SURVEY : III

Total Area

Comprised in

I, Michael Patrick Fiherty, being a person entitled to practise as a Licensed Cadastral Surveyor, certify that:
(a) The Surveys to which this dataset relates are accurate, and were undertaken by me or under my direction in accordance with the Cadastral Survey Act 2002 and the Surveyor General's Rules for Cadastral Survey 2002/2;
(b) This dataset is accurate and has been created in accordance with that Act and those Rules.

Signed at Rotorua 16/11/04 Date 13/10/04

Field Book.....p..... Traverse Book.....p.....

Reference Plans.....

Examined..... Correct.....

Approved as to Survey

...../...../..... Approving Surveyor

Deposited this.....day of.....20....

for Registrar-General of Land

File
Received 20-10-04
Instructions

SO 338996

LAND DISTRICT SOUTH AUCKLAND

NZMS 261 Sht RECORD MAP No

Section 1

TERRITORIAL AUTHORITY ROTORUA DISTRICT
Surveyed by Fiherty Survey and Mapping Ltd
Scale: 1: 5000 Date: JULY 2004

JTGC



Sec 1
(Lower Stratum)

Lake Tarawera

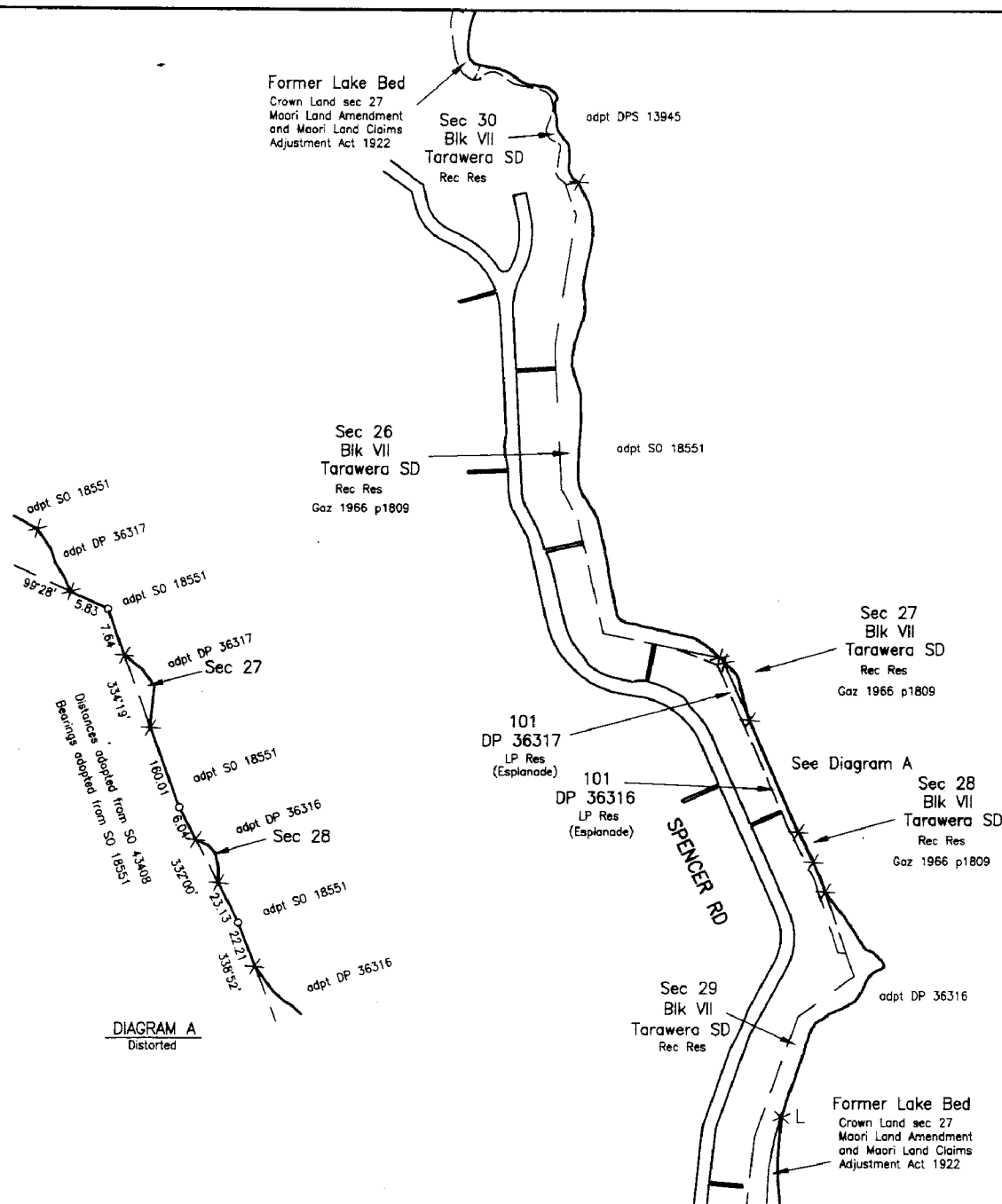

DIAGRAM A
Distorted

Approved as to Survey by
Land Information N.Z. on 16/11/2004
Deposited by Land Information N.Z.
on

Sheet 3 of 5

Approvals

CLASS OF SURVEY : III

Total Area

Comprised in

I, Michael Patrick Flaherty, being a person entitled to practise as a Licensed Cadastral Surveyor, certify that:
(a) The Surveys to which this dataset relates are accurate, and were undertaken by me or under my direction in accordance with the Cadastral Survey Act 2002 and the Surveyor General's Rules for Cadastral Survey 2002/2;
(b) This dataset is accurate and has been created in accordance with that Act and those Rules.

Signed at Rotorua [Signature] Date 13/10/04

Field Book.....p..... Traverse Book.....p.....

Reference Plans.....

Examined..... Correct.....

Approved as to Survey

...../...../..... Approving Surveyor

Deposited this.....day of.....20.....

for Registrar-General of Land

File
Received 20-10-04
Instructions

SO 338996

LAND DISTRICT SOUTH AUCKLAND

NZMS 261 Sht RECORD MAP No

Section 1

TERRITORIAL AUTHORITY ROTORUA DISTRICT
Surveyed by Flaherty Survey and Mapping Ltd
Scale: 1: 5000 Date: JULY 2004

JTGC

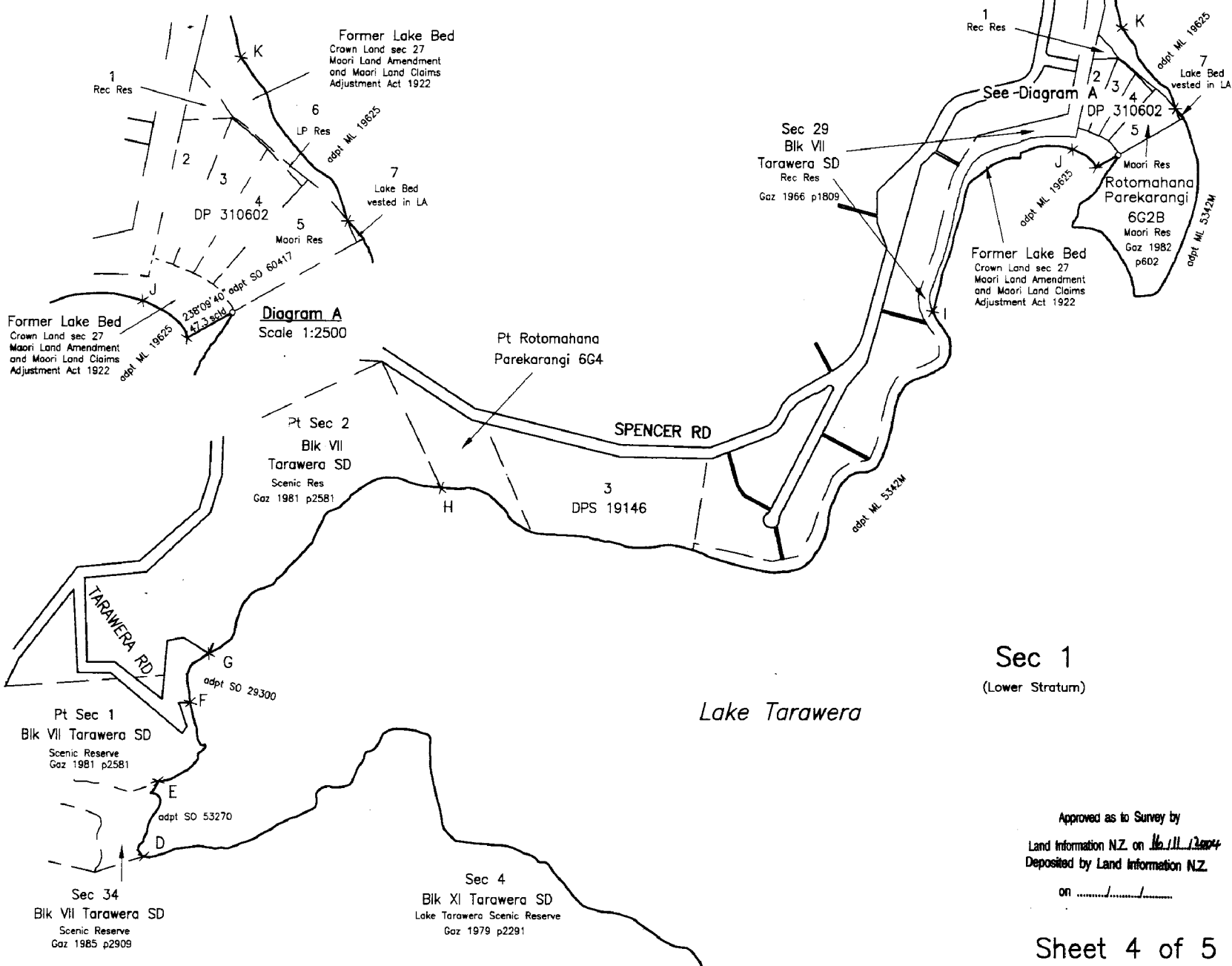

Diagram A
Scale 1:2500

Sec 1
(Lower Stratum)

Lake Tarawera

Approved as to Survey by
Land Information NZ on No. 111/13004
Deposited by Land Information NZ
on

Sheet 4 of 5

Approvals



CLASS OF SURVEY : III

Total Area

Comprised in

I, Michael Patrick Flaherty, being a person entitled to practise as a Licensed Cadastral Surveyor, certify that:
(a) The Surveys to which this dataset relates are accurate, and were undertaken by me or under my direction in accordance with the Cadastral Survey Act 2002 and the Surveyor General's Rules for Cadastral Survey 2002/2;
(b) This dataset is accurate and has been created in accordance with that Act and those Rules.

Signed at Rotorua Date 13/10/04

Field Book.....p..... Traverse Book.....p.....

Reference Plans.....

Examined..... Correct.....

Approved as to Survey

...../...../..... Approving Surveyor

Deposited this.....day of.....20...

for Registrar-General of Land

File Received 20-10-04
Instructions

SO 338996

LAND DISTRICT SOUTH AUCKLAND
NZMS 261 Sht RECORD MAP No

Section 1

TERRITORIAL AUTHORITY ROTORUA DISTRICT
Surveyed by Flaherty Survey and Mapping Ltd
Scale: 1: 5000 Date: JULY 2004

JTGC

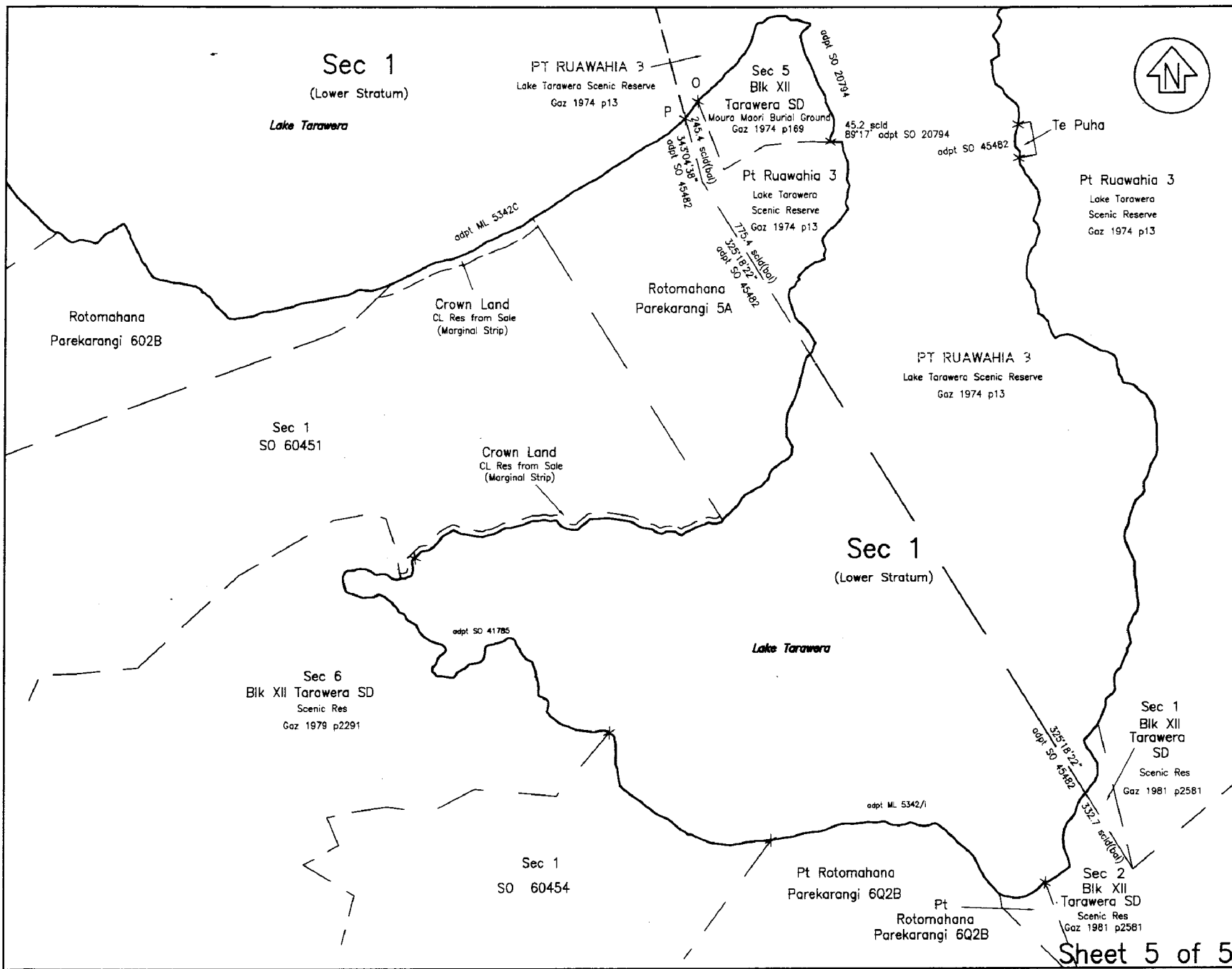

Approvals	
CLASS OF SURVEY : III	
Total Area	
Comprised in	
I, Michael Patrick Flaherty, being a person entitled to practise as a Licensed Cadastral Surveyor, certify that: (a) The Surveys to which this dataset relates are accurate, and were undertaken by me or under my direction in accordance with the Cadastral Survey Act 2002 and the Surveyor General's Rules for Cadastral Survey 2002/2; (b) This dataset is accurate and has been created in accordance with that Act and those Rules.	
Signed at Rotorua	Date 13/10/04
Field Book.....p.....	Traverse Book.....p.....
Reference Plans.....
Examined.....	Correct.....
Approved as to Survey by Land Information NZ on 16/11/2004	
Deposited by Land Information NZ on	
File Received 20-10-04 Instructions	SO 338996

Sheet 5 of 5

LAND DISTRICT SOUTH AUCKLAND
 NZMS 261 Sht RECORD MAP No

Section 1

TERRITORIAL AUTHORITY ROTORUA DISTRICT
 Surveyed by Flaherty Survey and Mapping Ltd
 Scale: 1: 10000 Date: JULY 2004
 JTGC

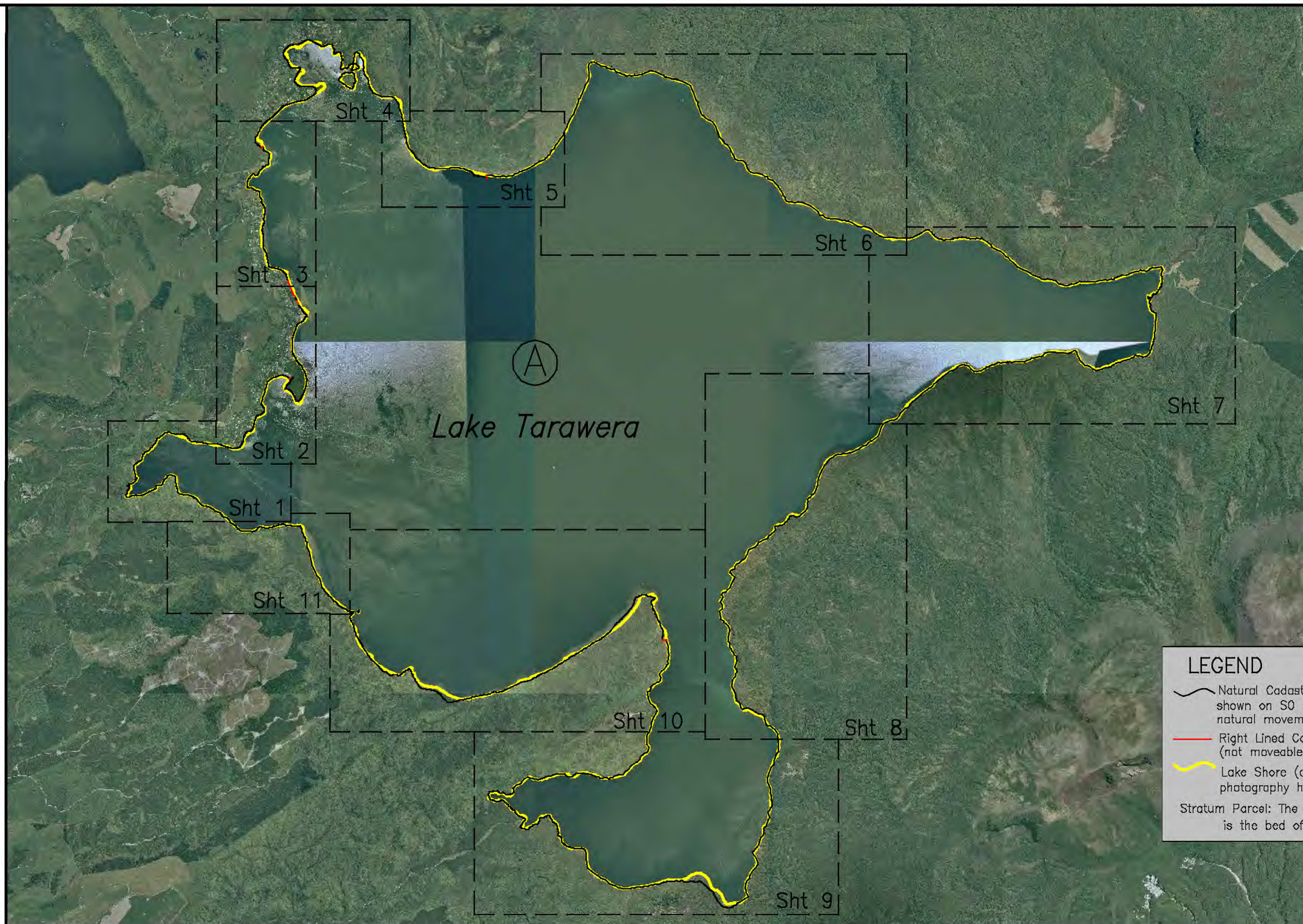
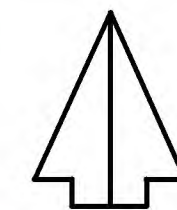

LEGEND

- Natural Cadastral Boundary – as shown on SO 338996 (subject to natural movement of the Lake Shore)
- Right Lined Cadastral Boundary (not moveable)
- Lake Shore (as depicted from photography hereon)

Stratum Parcel: The upper limit of Area A is the bed of Lake Tarawera



South Auckland Land District
 Territorial Authority :
 Rotorua District
 Date of Photography 2001
 Boundaries are Indicative Only

 John Taris Graphics Consultancy
 & Flaherty Survey & Mapping Ltd

Bed of Lake Tarawera
 (Shown A hereon containing 4148.4000ha more or less being Sec 1 SO 338996)

Area referred to in the Deed of Settlement between
 Te Arawa and the Crown

Approved as to Boundaries:
Roku Mihinui October 2004
 For and on behalf of Te Arawa
Kay Harrison October 2004
 For and on behalf of the Crown

INDEX	SO 340317
-------	-----------



LEGEND

- Natural Cadastral Boundary – as shown on SO 338996 (subject to natural movement of the Lake Shore)
- Right Lined Cadastral Boundary (not moveable)
- Lake Shore (as depicted from photography hereon)

Stratum Parcel: The upper limit of Area A is the bed of Lake Tarawera



South Auckland Land District
 Territorial Authority :
 Rotorua District
 Date of Photography 2001
 Boundaries are Indicative Only

John Taris Graphics Consultancy
 & Flaherty Survey & Mapping Ltd

Bed of Lake Tarawera

(Shown A hereon containing 4148.4000ha more or less being Sec 1 SO 338996)

Area referred to in the Deed of Settlement between
 Te Arawa and the Crown

Approved as to Boundaries:

Roku Mihinui October 2004
 For and on behalf of Te Arawa

Kay Harrison October 2004
 For and on behalf of the Crown

1 of 11 SO 340317



LEGEND

— Natural Cadastral Boundary – as shown on SO 338996 (subject to natural movement of the Lake Shore)

— Right Lined Cadastral Boundary (not moveable)

— Lake Shore (as depicted from photography hereon)

Stratum Parcel: The upper limit of Area A is the bed of Lake Tarawera

Ⓐ
Lake Tarawera

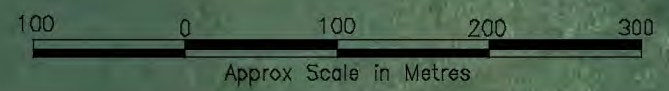

South Auckland Land District
Territorial Authority :
Rotorua District
Date of Photography 2001
Boundaries are Indicative Only

John Taris Graphics Consultancy
& Flaherty Survey & Mapping Ltd

Bed of Lake Tarawera
(Shown A hereon containing 4148.4000ha more or less being Sec 1 SO 338996)



Area referred to in the Deed of Settlement between
Te Arawa and the Crown

Approved as to Boundaries:
Raku Mihinui October 2004
For and on behalf of Te Arawa
Kay Harrison October 2004
For and on behalf of the Crown

2 of 11 | SO 340317



LEGEND

-  Natural Cadastral Boundary – as shown on SO 338996 (subject to natural movement of the Lake Shore)
-  Right Lined Cadastral Boundary (not moveable)
-  Lake Shore (as depicted from photography hereon)

Stratum Parcel: The upper limit of Area A is the bed of Lake Tarawera



South Auckland Land District
 Territorial Authority :
 Rotorua District
 Date of Photography 2001
 Boundaries are Indicative Only

 John Taris Graphics Consultancy
 & Flaherty Survey & Mapping Ltd

Bed of Lake Tarawera
 (Shown A hereon containing 4148.4000ha more or less being Sec 1 SO 338996)

Area referred to in the Deed of Settlement between
 Te Arawa and the Crown

Approved as to Boundaries:
Raku Mihinui October 2004
 For and on behalf of Te Arawa
Kay Harrison October 2004
 For and on behalf of the Crown

3 of 11 SO 340317

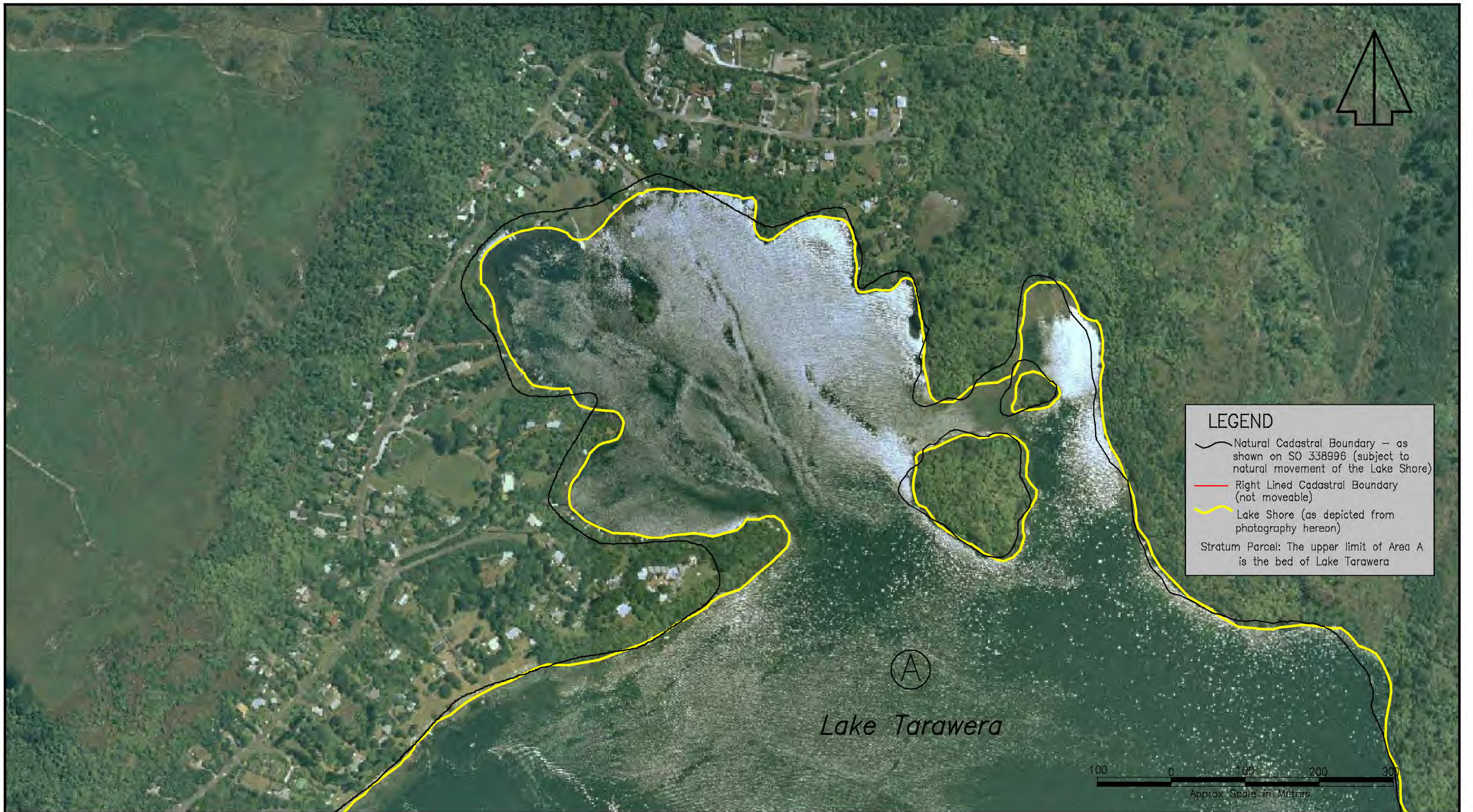

LEGEND

- Natural Cadastral Boundary – as shown on SO 338996 (subject to natural movement of the Lake Shore)
- Right Lined Cadastral Boundary (not moveable)
- Lake Shore (as depicted from photography hereon)

Stratum Parcel: The upper limit of Area A is the bed of Lake Tarawera

(A)
Lake Tarawera

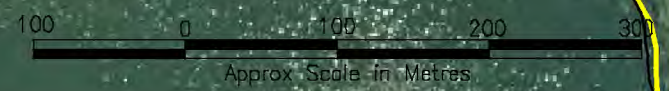

South Auckland Land District
Territorial Authority :
Rotorua District
Date of Photography 2001
Boundaries are Indicative Only

John Taris Graphics Consultancy
& Flaherty Survey & Mapping Ltd

Bed of Lake Tarawera
(Shown A hereon containing 4148.4000ha more or less being Sec 1 SO 338996)

Area referred to in the Deed of Settlement between
Te Arawa and the Crown

Approved as to Boundaries:
Roku Mihinui October 2004
For and on behalf of Te Arawa
Kay Harrison October 2004
For and on behalf of the Crown

4 of 11 | SO 340317



South Auckland Land District
 Territorial Authority :
 Rotorua District
 Date of Photography 2001
 Boundaries are Indicative Only
 John Taris Graphics Consultancy
 & Flaherty Survey & Mapping Ltd

Bed of Lake Tarawera
 (Shown A hereon containing 4148.4000ha more or less being Sec 1 SO 338996)

Area referred to in the Deed of Settlement between
 Te Arawa and the Crown

Approved as to Boundaries:
Roku Mihinui October 2004
 For and on behalf of Te Arawa
Kay Harrison October 2004
 For and on behalf of the Crown

5 of 11 | SO 340317



South Auckland Land District
 Territorial Authority :
 Rotorua District
 Date of Photography 2001
 Boundaries are Indicative Only
 John Taris Graphics Consultancy
 & Flaherty Survey & Mapping Ltd

Bed of Lake Tarawera
 (Shown A hereon containing 4148.4000ha more or less being Sec 1 SO 338996)

Area referred to in the Deed of Settlement between
 Te Arawa and the Crown

Approved as to Boundaries:
Roku Mihinui October 2004
 For and on behalf of Te Arawa
Kay Harrison October 2004
 For and on behalf of the Crown

6 of 11 | SO 340317

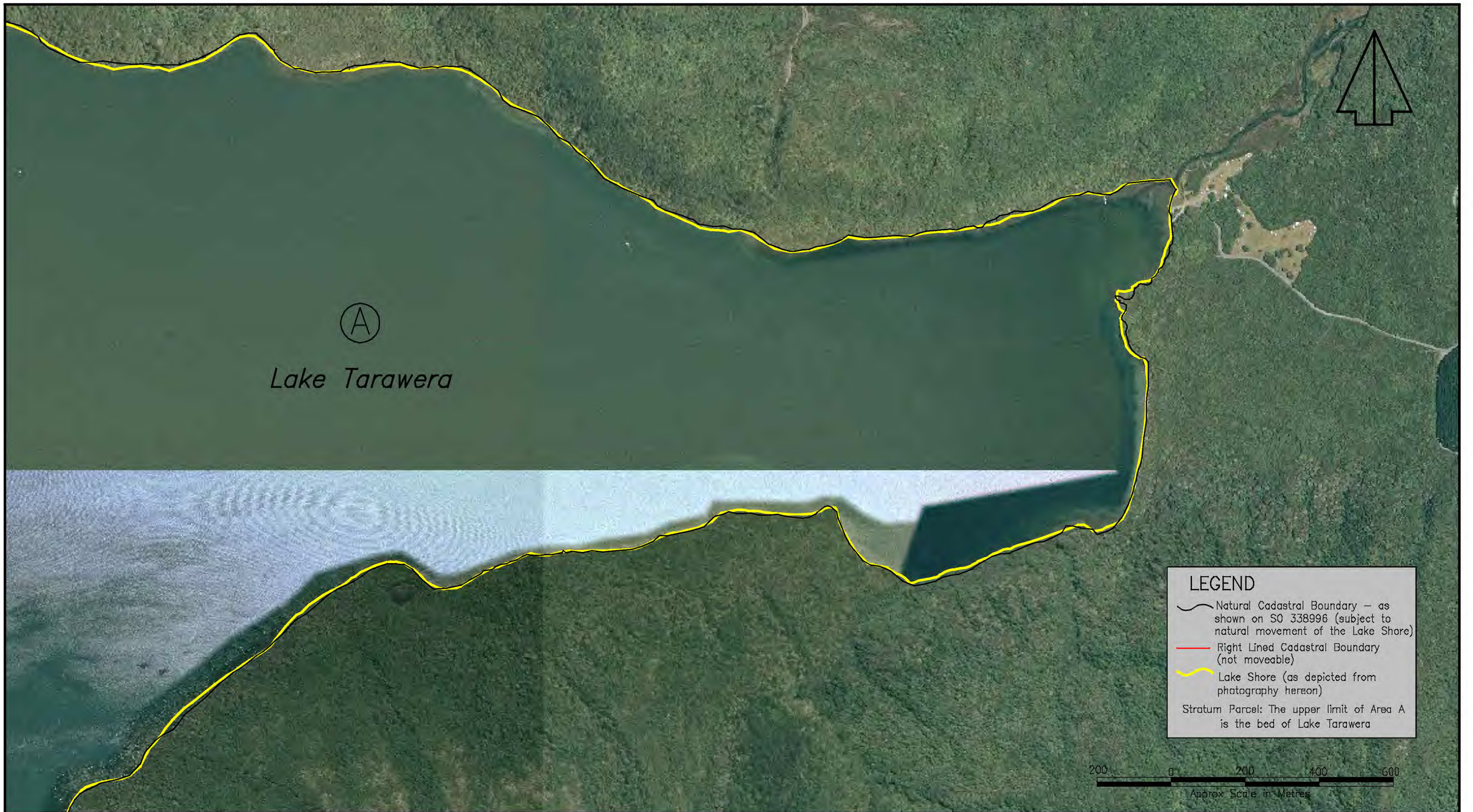

South Auckland Land District
Territorial Authority :
Rotorua District
Date of Photography 2001
Boundaries are Indicative Only

John Taris Graphics Consultancy
& Flaherty Survey & Mapping Ltd

Bed of Lake Tarawera
(Shown A hereon containing 4148.4000ha more or less being Sec 1 SO 338996)

Area referred to in the Deed of Settlement between
Te Arawa and the Crown

Approved as to Boundaries:
Roku Mihinui October 2004
For and on behalf of Te Arawa
Kay Harrison October 2004
For and on behalf of the Crown

7 of 11 | SO 340317



Ⓐ
Lake Tarawera

Bed of Lake Tarawera

(Shown A hereon containing 4148.4000ha more or less being Sec 1 SO 338996)

Area referred to in the Deed of Settlement between
Te Arawa and the Crown

Approved as to Boundaries:
Roku Mihinui October 2004
 For and on behalf of Te Arawa
Kay Harrison October 2004
 For and on behalf of the Crown

8 of 11 | SO 340317



South Auckland Land District
 Territorial Authority :
 Rotorua District
 Date of Photography 2001
 Boundaries are Indicative Only
 John Taris Graphics Consultancy
 & Flaherty Survey & Mapping Ltd



LEGEND

- Natural Cadastral Boundary – as shown on SO 338996 (subject to natural movement of the Lake Shore)
- Right Lined Cadastral Boundary (not moveable)
- Lake Shore (as depicted from photography hereon)

Stratum Parcel: The upper limit of Area A is the bed of Lake Tarawera



South Auckland Land District
 Territorial Authority :
 Rotorua District
 Date of Photography 2001
 Boundaries are Indicative Only
 John Taris Graphics Consultancy
 & Flaherty Survey & Mapping Ltd

Bed of Lake Tarawera
 (Shown A hereon containing 4148.4000ha more or less being Sec 1 SO 338996)

Area referred to in the Deed of Settlement between
 Te Arawa and the Crown

Approved as to Boundaries:
Roku Mihinui October 2004
 For and on behalf of Te Arawa
Kay Harrison October 2004
 For and on behalf of the Crown

9 of 11 | SO 340317



South Auckland Land District
Territorial Authority :
Rotorua District
Date of Photography 2001
Boundaries are Indicative Only

John Taris Graphics Consultancy
& Flaherty Survey & Mapping Ltd

Bed of Lake Tarawera
(Shown A hereon containing 4148.4000ha more or less being Sec 1 SO 338996)

Area referred to in the Deed of Settlement between
Te Arawa and the Crown

Approved as to Boundaries:
Roku Mihinui October 2004
For and on behalf of Te Arawa
Kay Harrison October 2004
For and on behalf of the Crown

10 of 11 | SO 340317



LEGEND

— Natural Cadastral Boundary – as shown on SO 338996 (subject to natural movement of the Lake Shore)

— Right Lined Cadastral Boundary (not moveable)

— Lake Shore (as depicted from photography hereon)

Stratum Parcel: The upper limit of Area A is the bed of Lake Tarawera

100 0 100 200 300
Approx Scale in Metres



South Auckland Land District
Territorial Authority :
Rotorua District
Date of Photography 2001
Boundaries are Indicative Only

John Taris Graphics Consultancy
& Flaherty Survey & Mapping Ltd

Bed of Lake Tarawera
(Shown A hereon containing 4148.4000ha more or less being Sec 1 SO 338996)

Area referred to in the Deed of Settlement between
Te Arawa and the Crown

Approved as to Boundaries:
Raku Mihinui October 2004
For and on behalf of Te Arawa
Kay Harrison October 2004
For and on behalf of the Crown

11 of 11 | SO 340317