

Platform 01: The Cutting Concept.

Existing 4WD Gravel track
from Omanawa Road &
Towards proposed upgraded track access.



Aerial Base:
7813 - D Lot 1 DPS 51590 & Lot 1 DPS 82722
By RCP. Jan 2021.

Existing Beam above.

Steep bank below.

Approx. 2.5m

Existing Cable Infrastructure / Power Station pulley.



Location Plan.
To be read in conjunction with Masterplan.

Platform 01: The Cutting.

- | | |
|----|---|
| 1. | Existing path interfaces with proposed platform. |
| 2. | Platform extends out on a flat plain.
Materiality options for low reflectivity, recessive colours & materials. I.e, timber steps with gravel infil, expanded steel mesh, timber decking & handrail/balustrade. |
| 3. | Balustrade along front and side edges.
Opportunity to include Mahi Toi. |
| 4. | Balustrade continues into gate to match. |
| 5. | Existing timber stairs reformed to tie into deck level. |
| 6. | Proposed safety gate at base of steps. |
| 7. | Existing track towards tunnel remains, for authorised access only. |

Client: Tauranga City Council
Issued For: Resource Consent
Rev: /
Issued: 31.03.21



A diagram showing a stepped profile with horizontal segments labeled 0m, 2.5m, and 5m. The profile consists of several horizontal and vertical steps. The horizontal segments are labeled with their lengths: 0m, 2.5m, and 5m.

Dw Nb: IGL_4304_SK_Platform_01	Scale: 1:100 @ A3
Dw: JT	Rv: AN

**View to
Omanawa Falls.**

Project: OMANAWA FALLS
Job No.: 1015067.3000
Description: PLATFORM 1 CONCEPT SKETCH
Computed: ZKC 04/05/2021

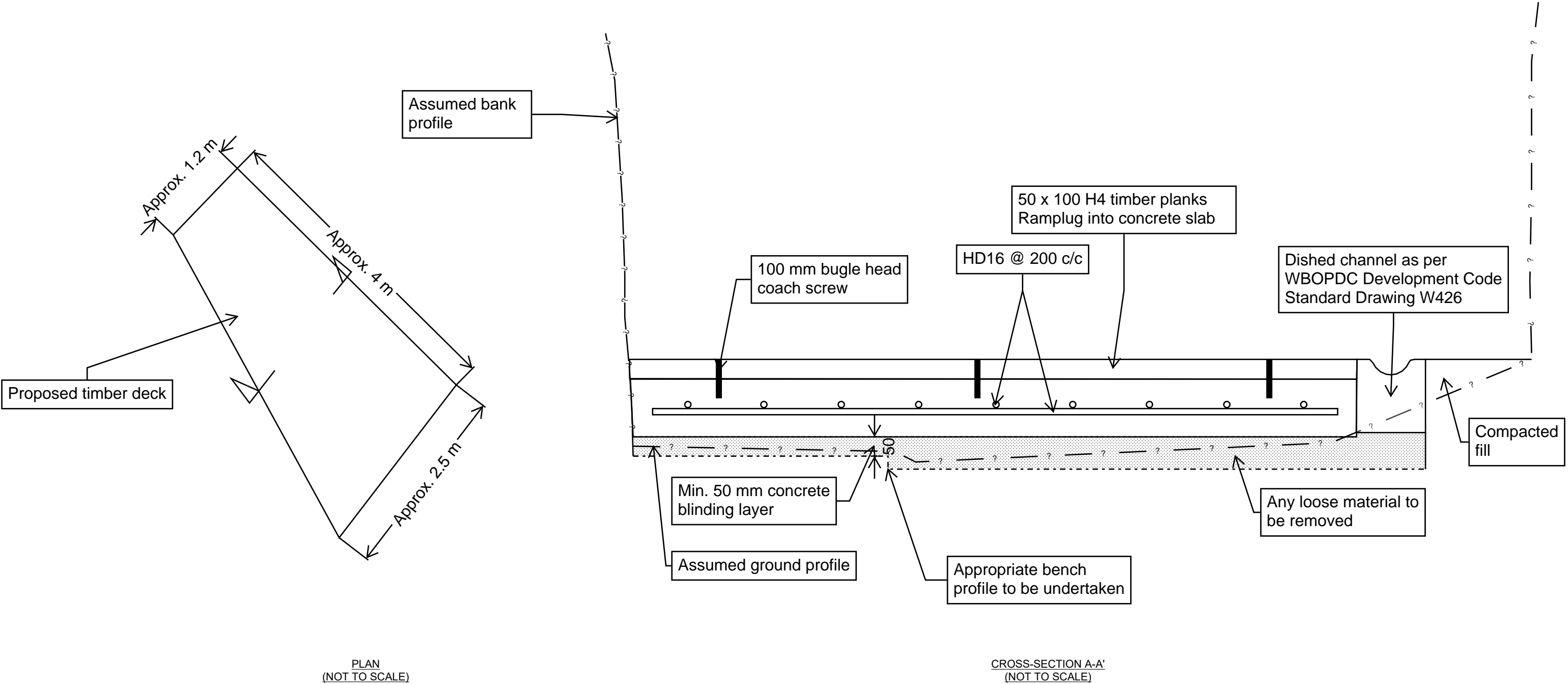

- Notes:
1. All dimensions are in millimeters unless noted otherwise
 2. All timber: Radiata Pine
 3. All elements to be confirmed during detailed design

Platform 02: Upper Platform Concept.

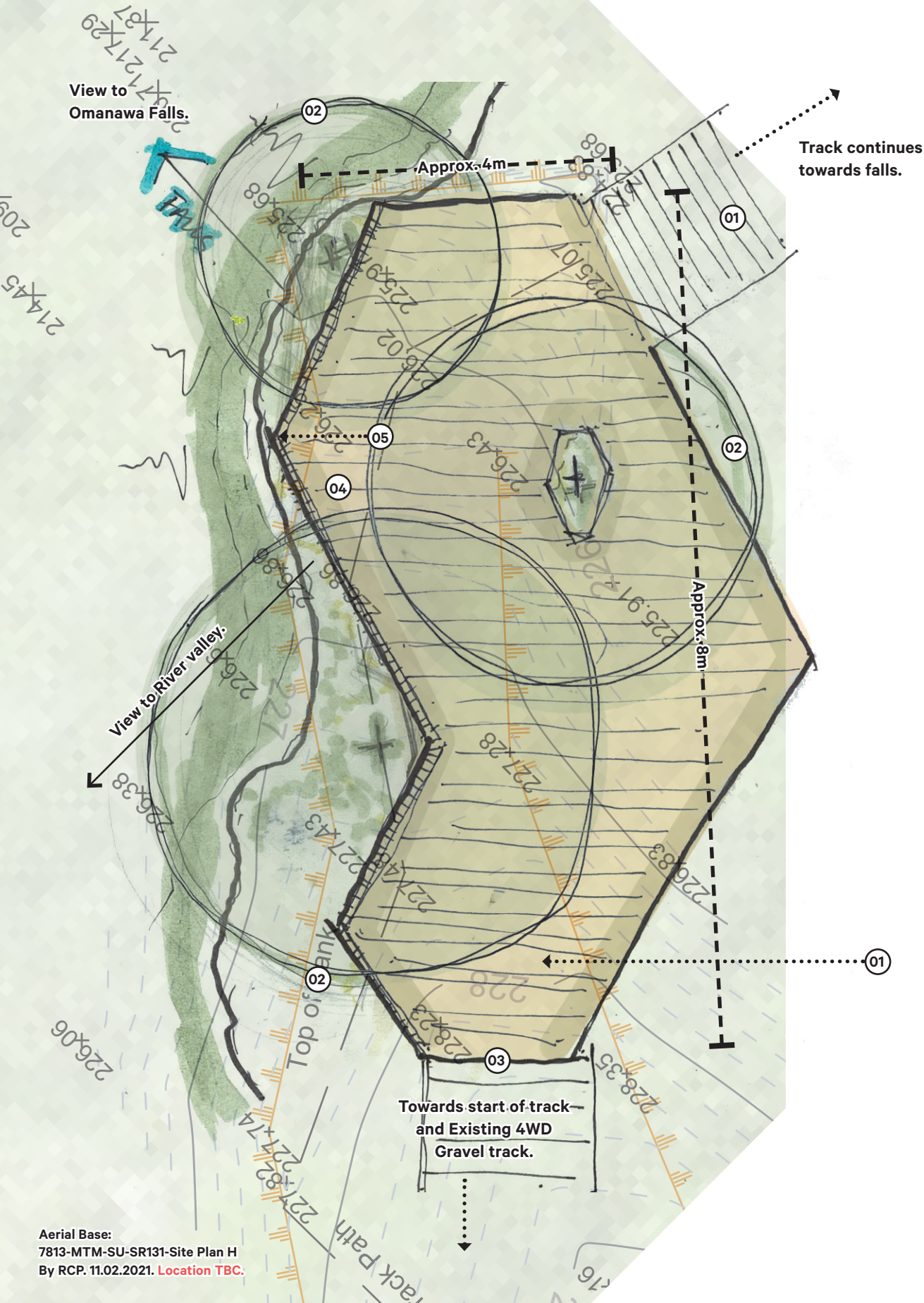

Project: OMANAWA FALLS
Job No.: 1015067.3000
Description: UPPER PLATFORM LOOKOUT CONCEPT SKETCH
Computed: ZKC 20/05/2021

Notes:
All elements to be confirmed during detailed design.

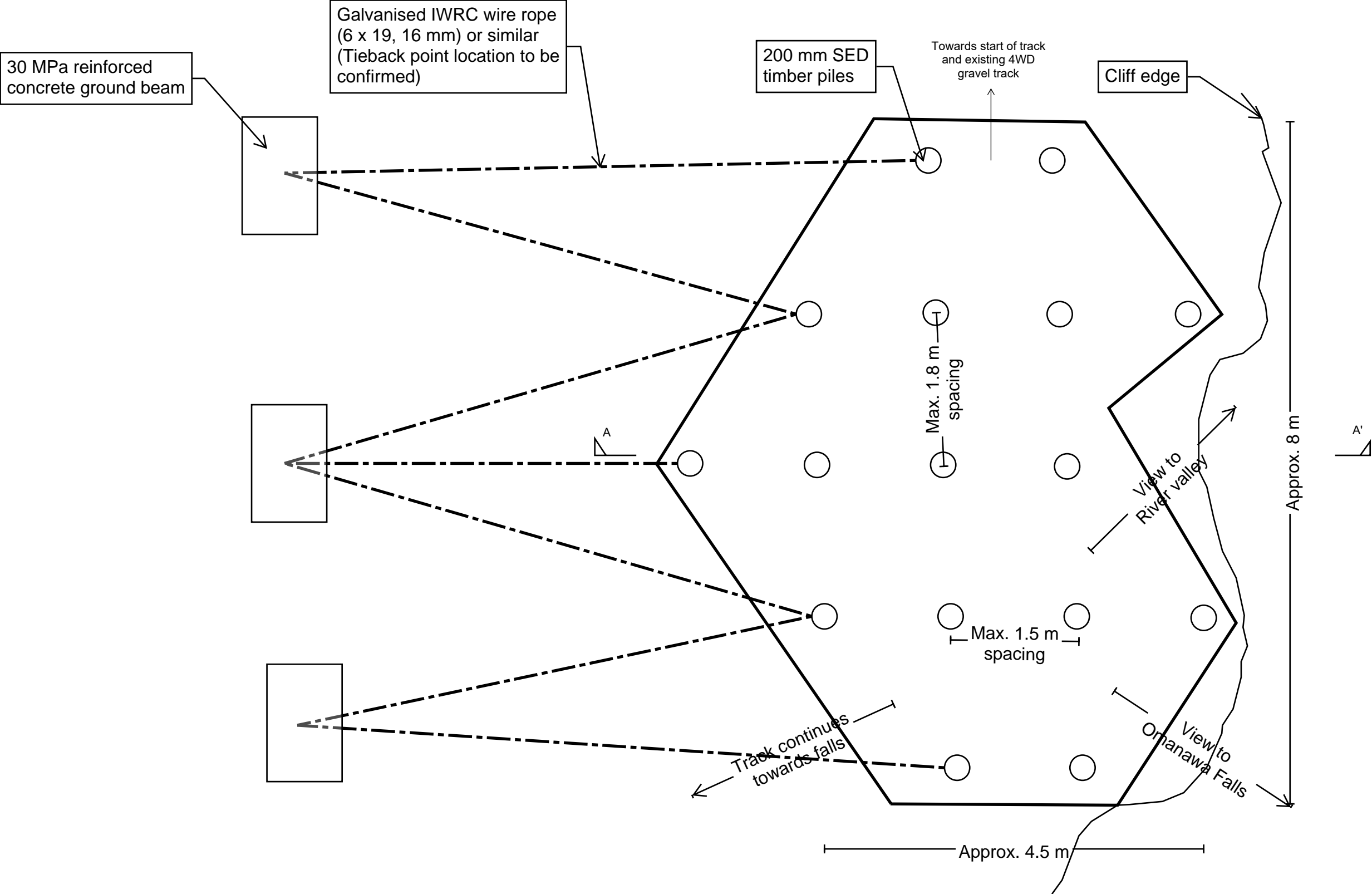

PLAN
(NOT TO SCALE)

Project: OMANAWA FALLS
Job No.: 1015067.3000
Description: UPPER PLATFORM LOOKOUT CROSS-SECTION A-A' CONCEPT SKETCH
Computed: ZKC 20/05/2021

Notes:
All elements to be confirmed during detailed design.

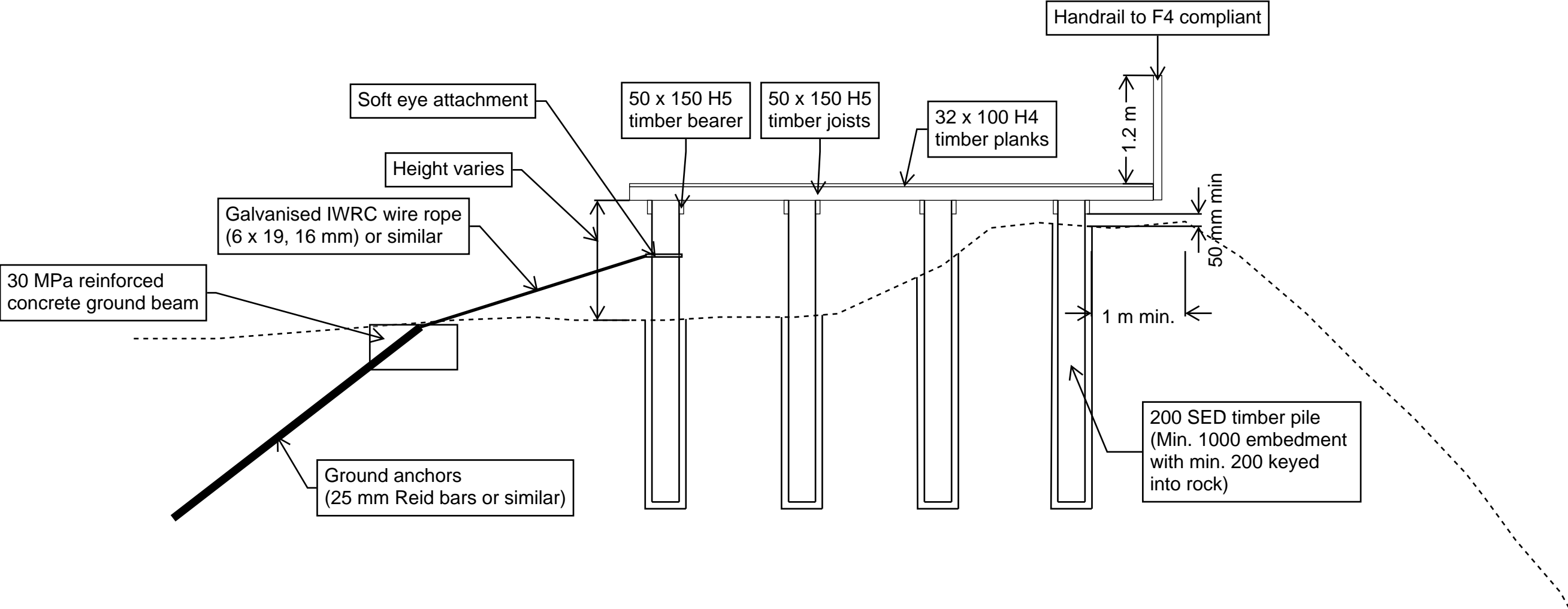

CROSS-SECTION A-A'
(NOT TO SCALE)

Platform 03: Lower Platform Concept.

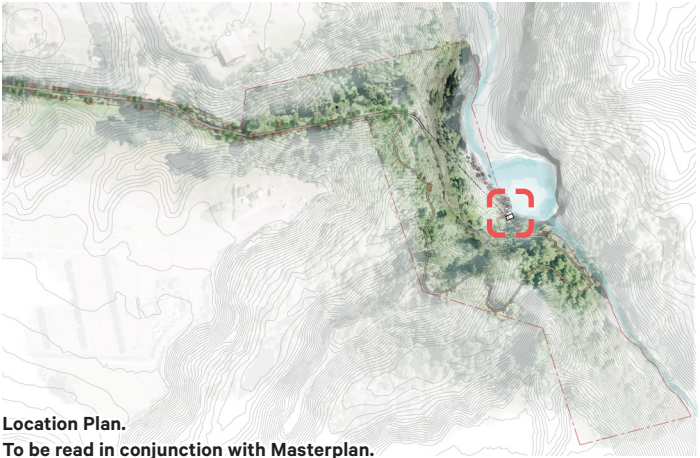

Location Plan.
To be read in conjunction with Masterplan.

Platform 03: Lower Platform.

- | | |
|----|--|
| 1. | Existing stairs down to power station platform. |
| 2. | No access to existing platform. |
| 3. | Existing stair landing extended to allow for new stair connection down to boulders. |
| 4. | Transitions between platforms & boulders; infill decking fixed to boulders, to step as necessary to required level change. Opportunity to include Mahi Toi. |
| 5. | <u>Intermediate Platform</u> on a single flat plain. Materiality options for low reflectivity, recessive colours & materials. I.e. timber steps with gravel infil, expanded steel mesh, timber decking & handrail/balustrade. Sub-structure fixed to boulders, timber to be cut around existing boulders to fit. Opportunity to include Mahi Toi. |
| 6. | <u>Lower Platform</u> on a single flat plain. Materiality options for low reflectivity, recessive colours & materials. I.e. timber steps with gravel infil, expanded steel mesh, timber decking & handrail/balustrade. Fixed to boulders. Potential to clad elevation. Platform to close off voids below. Potential works around existing stone subject to discussion with Ngāti Hangarau. Sub-structure fixed to boulders, timber to be cut around existing boulders to fit. Opportunity to include Mahi Toi. |
| 7. | Informal stepped access to lower boulders. |

Client: Tauranga City Council
Issued For: Resource Consent
Rev: /
Issued: 31.03.21

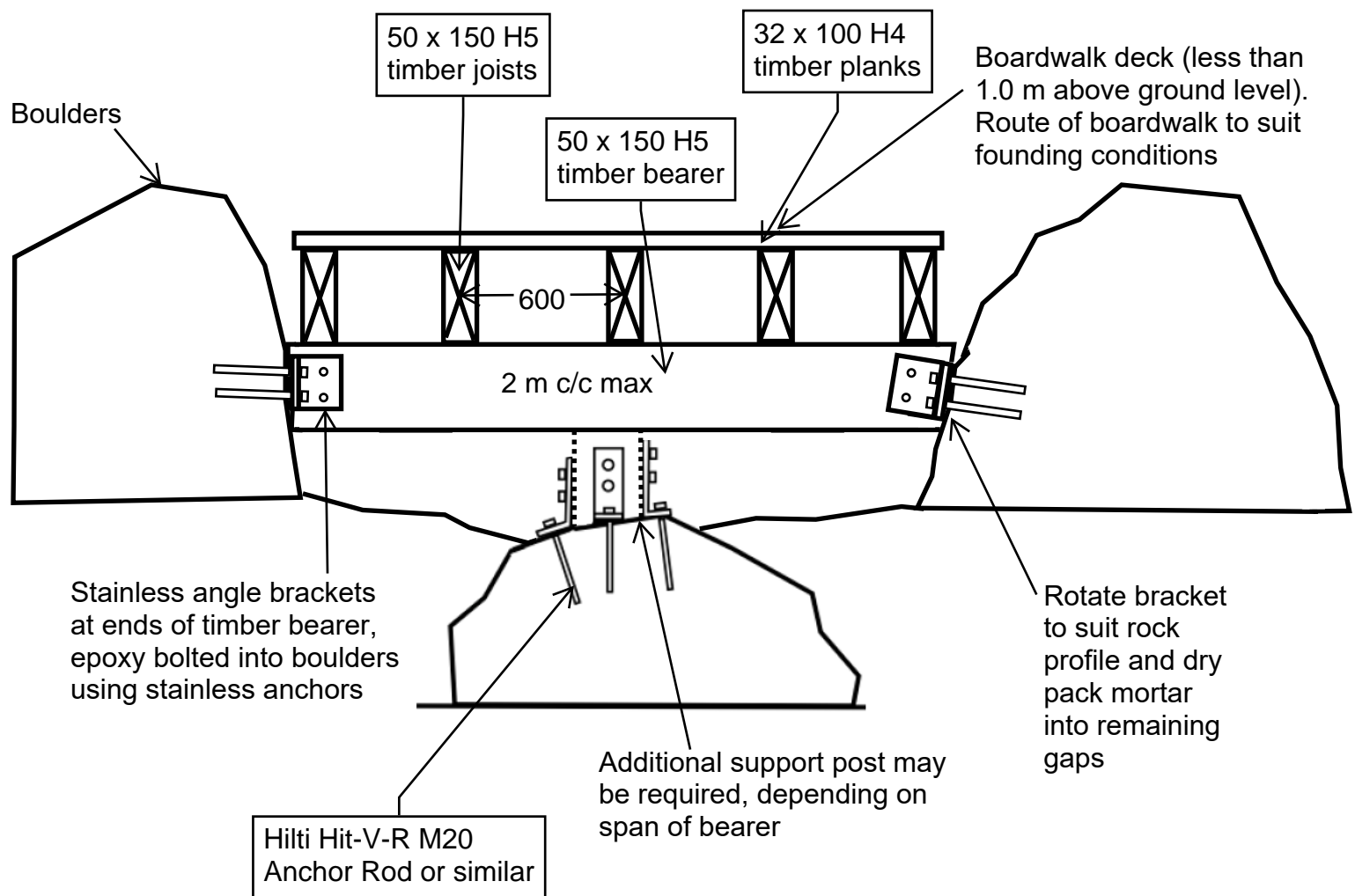

Notes:

1. All dimensions are in millimeters unless noted otherwise
2. All timber: Radiata Pine
3. All stainless steel to be Grade 316
4. All elements to be confirmed during detailed design

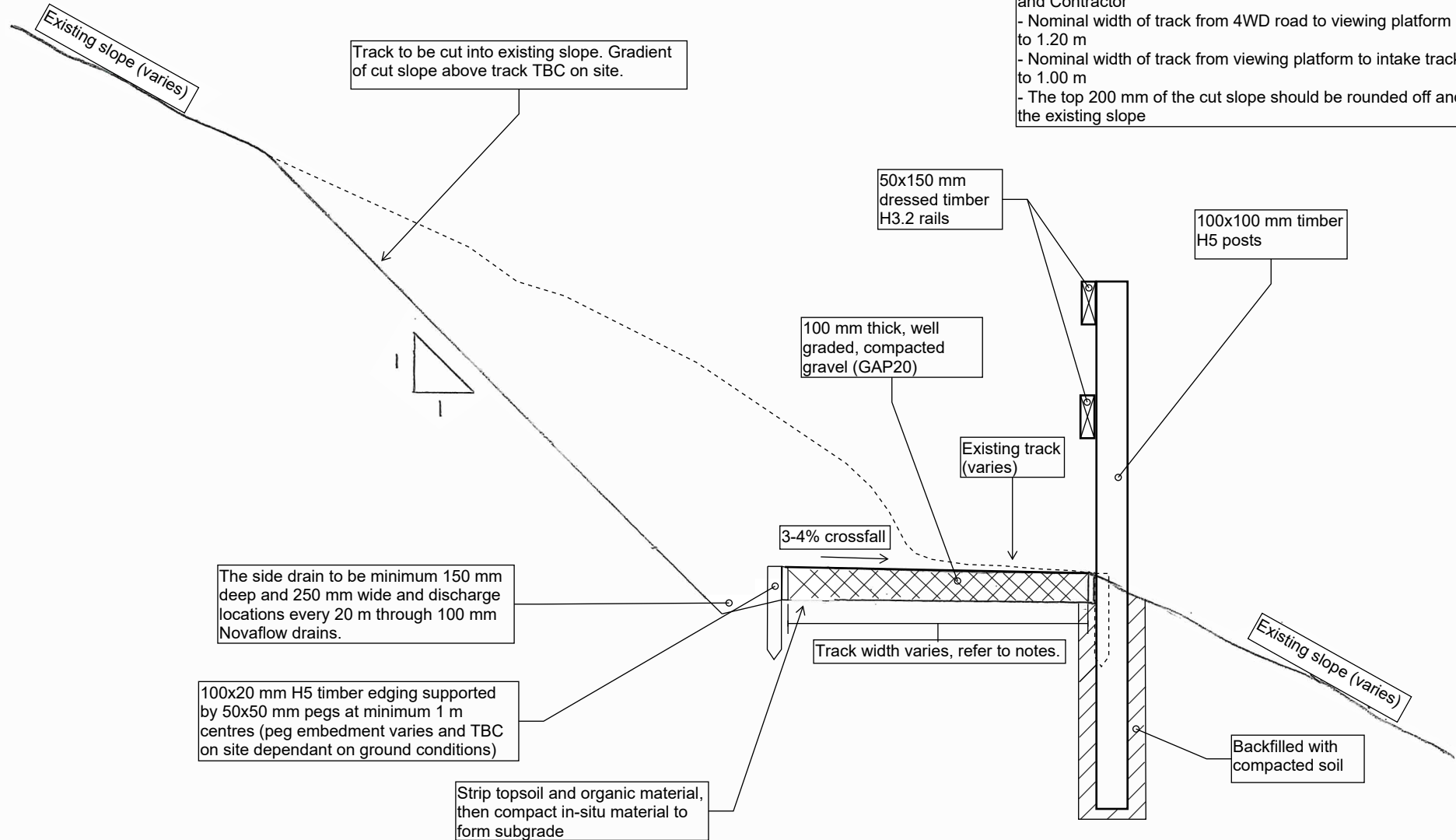

Notes:

- Tracks and access structures to be in general accordance with SNZ HB 8630:2004 Tracks and Outdoor Visitor Structures, and Department of Conservation Track Construction & Maintenance Guidelines
- Alignment and gradient to be confirmed on site with the Engineer and Contractor
- Nominal width of track from 4WD road to viewing platform is 0.75 m to 1.20 m
- Nominal width of track from viewing platform to intake track - 0.60 m to 1.00 m
- The top 200 mm of the cut slope should be rounded off and tied into the existing slope

Cross-Section 01: Indicative Proposed Gravel Track

Sketch No. 1015067.3000-01 Rev0
Not To Scale (N.T.S)

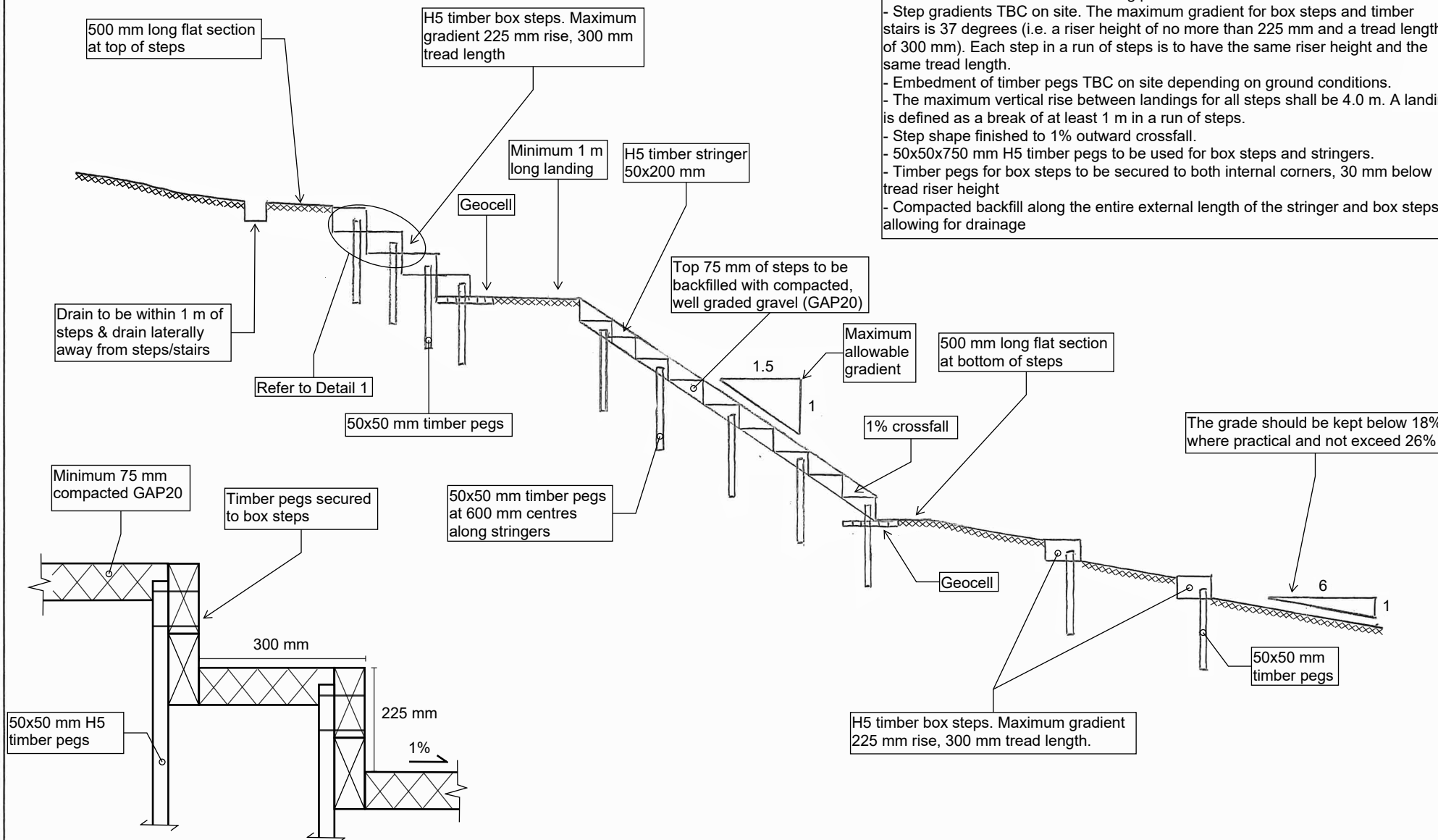

Notes:

- Tracks and access structures to be in general accordance with SNZ HB 8630:2004 Tracks and Outdoor Visitor Structures, and Department of Conservation Track Construction & Maintenance Guidelines
- Alignment and gradient to be confirmed on site with the Engineer and Contractor
- Nominal width of track from 4WD road to viewing platform is 0.75 m to 1.20 m
- Nominal width of track from viewing platform to intake track - 0.60 m to 1.00 m
- Step gradients TBC on site. The maximum gradient for box steps and timber stairs is 37 degrees (i.e. a riser height of no more than 225 mm and a tread length of 300 mm). Each step in a run of steps is to have the same riser height and the same tread length.
- Embedment of timber pegs TBC on site depending on ground conditions.
- The maximum vertical rise between landings for all steps shall be 4.0 m. A landing is defined as a break of at least 1 m in a run of steps.
- Step shape finished to 1% outward crossfall.
- 50x50x750 mm H5 timber pegs to be used for box steps and stringers.
- Timber pegs for box steps to be secured to both internal corners, 30 mm below tread riser height
- Compacted backfill along the entire external length of the stringer and box steps allowing for drainage

Detail 1: Box Steps
(Not to scale)

Long-Section 01: Indicative Proposed Gravel Track & Box Steps

Sketch No. 1015067.3000-02 Rev0
Not To Scale (N.T.S)

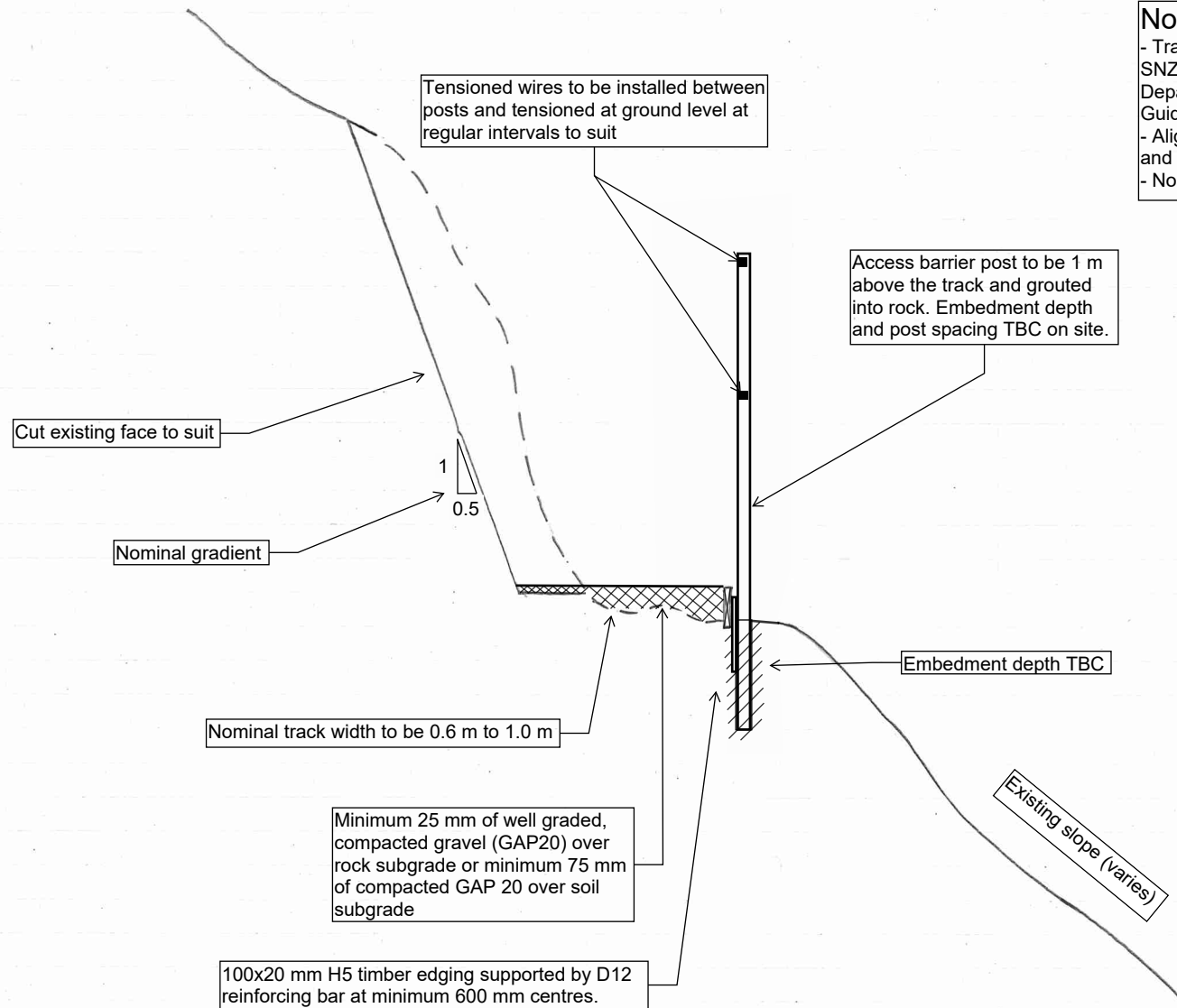

Notes:

- Tracks and access structures to be in general accordance with SNZ HB 8630:2004 Tracks and Outdoor Visitor Structures, and Department of Conservation Track Construction & Maintenance Guidelines
- Alignment and gradient to be confirmed on site with the Engineer and Contractor
- Nominal width of in-take track - 0.60 m to 1.00 m

Cross-Section 02: Indicative Proposed In-Take Track

Sketch No. 1015067.3000-03 Rev0
Not To Scale (N.T.S)

Description: LADDER FOUNDATION
CONCEPT SKETCH

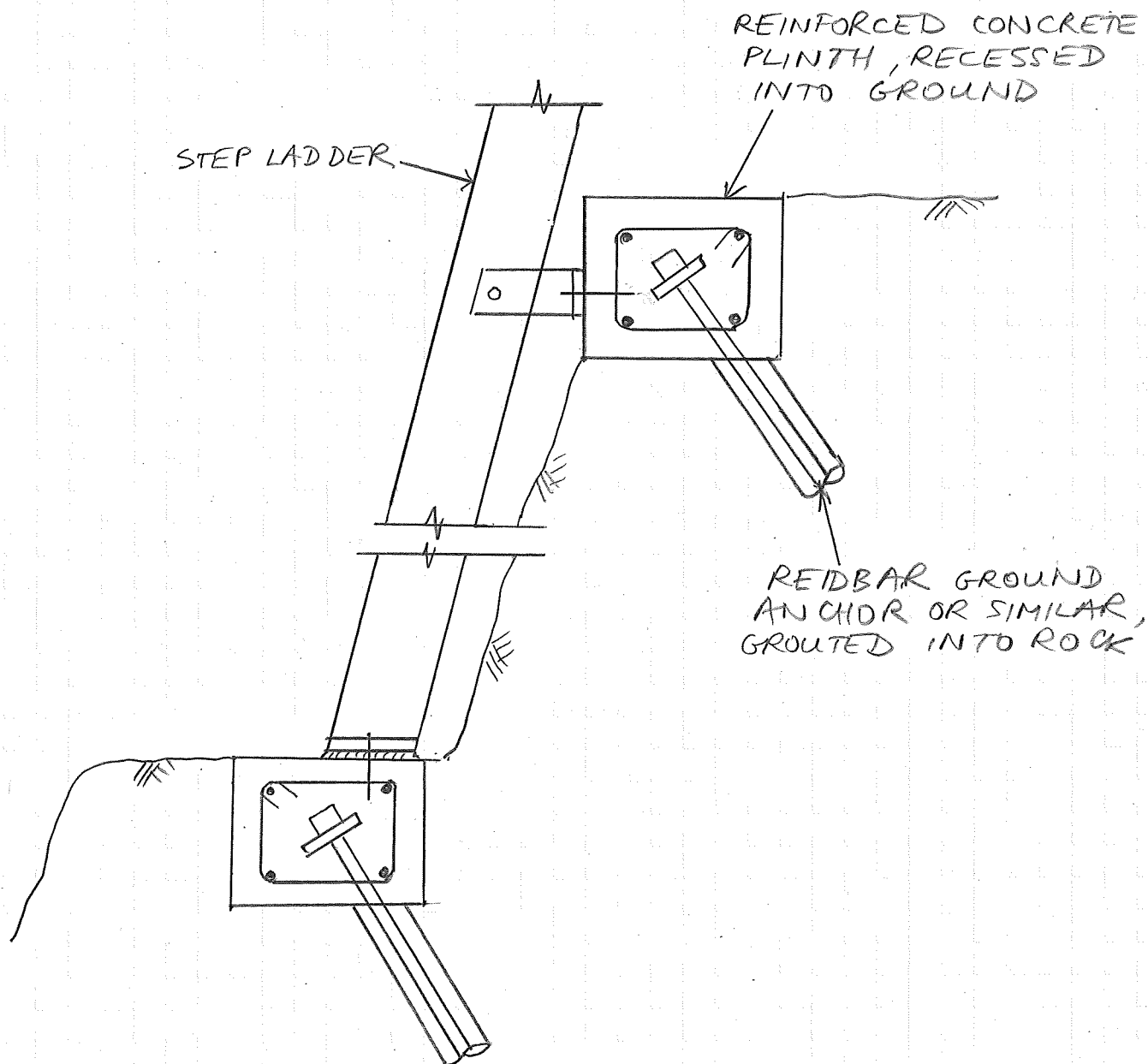

LADDER FOUNDATION

CONCEPT SKETCH

(NOT TO SCALE)